

Forged Pear Link

- Standard :EN1677-4.
- Forged super alloy steel-Quenched and tempered.
- Individually proof test at 2.5 times working load limit.
- Fatiuge tested for 20000 cycles.
- Breakage test.
- 100% magnaflux crack detection.
- Safety factor 4:1
- Surface finish: Powder plastified.

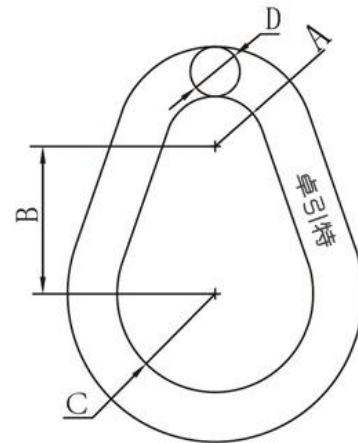

ITEM No.	WLL	Breaking Strength	Size (mm)				Weight
	T		A	B	C	D	
8-034-3/8	1.6	8	10	28.5	19	10	0.1
8-034-1/2	3.2	16	12.5	38	25.5	12.5	0.25
8-034-5/8	4.1	20.5	16	47.5	32	16	0.5
8-034-3/4	5.6	28	19	57	38	19	0.8
8-034-7/8	6.4	32	22	67	44.5	22.2	1.4
8-034-1	11	55	25	76	51	25.4	1.9
8-034-1 1/8	13.9	69.5	28	86	57	28.5	2.92