

## Clevis Selflock Hook

- Forged super alloy steel-Quenched and tempered
- Individually proof test at 2.5 times working load limit.
- Fatiuge tested for 20000 cycles.
- Breakage test
- 100% magnaflux crack detection.
- Suitable for EN818-2 G80 chain.
- Safety factor 4:1
- Surface finish: Powder plastified.

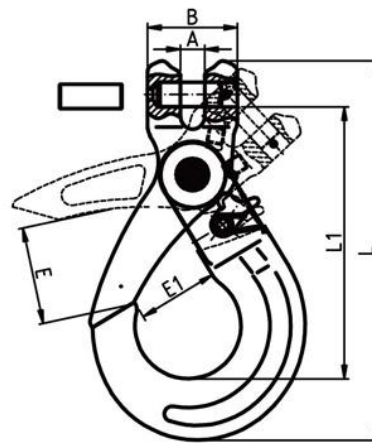

ITEM No.	WLL	Breaking Strength	Size ( mm )						Weight
	T		T	A±1	B±1	E±2	E1±2	L1±3	L±3
8-738-06	1.12	4.48	8	32	35	28	96	131	0.44
8-738-08	2	8	9.5	38.5	40	35.8	119.3	161.8	0.8
8-738-10	3.15	12.6	12.5	46	50	45	142	195	1.38
8-738-13	5.3	21.2	15	59	60	52.5	179	249	2.81
8-738-16	8	32	18.5	77	65	63.3	224.8	310	6
8-738-20	12.5	50	25	77	80	76	238.3	335	7.25
8-738-22	15	60	25	97.5	83	86	277	392	12.8
8-738-26	21.2	84.8	30	118	106	96	321	450	21.8
8-738-32	31.5	126	35	150	140	135	416	589.6	49.6

## G100 Clevis Selflock Hook

- Forged super alloy steel-Quenched and tempered.
- 25% stronger than G80.
- Individually proof test at 2.5 times working load limit.
- Fatiuge tested for 20000 cycles.
- Breakage test
- 100% magnaflux crack detection.
- Suitable for G100 chain.
- Safety factor 4:1
- Surface finish: Powder plastified.

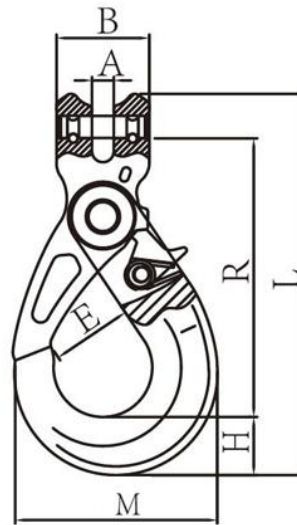

ITEM No.	WLL	Breaking Strength	Size ( mm )							Weight
	T		T	A±0.5	B±1	E±1	H±1	R±2	M±2	
10-1006-06	1.4	5.6	7.5	32	28	20	96	70	131	0.5
10-1006-08	2.5	10	9.5	36	35.5	26	123	90	166	0.9
10-1006-10	4	16	12	46	45	30	144	109	196.5	1.6
10-1006-13	6.7	26.8	15	59	53.5	40.5	182	138.5	251	2.9
10-1006-16	10	40	17.5	70	62	50.5	217	170.5	303	5.8
10-1006-20	16	64	25	85	76.5	62	235	192.5	337.5	8.6
10-1006-22	19	76	25.5	98	80	66	276.5	205	391	12.1